

Table of Contents

1	Intended Use of the iSleep 20i	3
1.1	What is the iSleep 20i?	3
1.2	Indications for Use	4
1.3	Contraindications	4
1.4	About this Manual	5
2	Safety Information	7
2.1	General User Precautions	7
2.2	Electrical Safety	8
2.3	Environmental Conditions	9
2.4	Usage of Patient Circuit	10
2.5	Usage of Filters	10
2.6	Cleaning and Maintenance	11
2.7	Adverse Patient Symptoms	12
2.8	Usage of the HA 01 Humidifier	13
2.9	Usage of Oxygen	14
3	Product Description	15
3.1	Main Components	15
3.2	Accessories	17
3.3	The iSleep 20i's Front Panel	18
3.4	The iSleep 20i's Side Panels	19
3.5	Equipment Designation and Safety Label	20
4	Functions and Parameters of the iSleep 20i	21
4.1	Function Modes	21
4.2	Settings	21
5	Using the iSleep 20i	23
5.1	Checking the iSleep 20i before Use	23
5.2	Switching the iSleep 20i On and Off	23
5.3	Using the Menu	24
5.4	Using the integrated HA 01 Humidifier	25
5.5	Using an External Battery	26
6	Preparing the iSleep 20i for Use	28
6.1	Installing the iSleep 20i	28
6.2	Placing the iSleep 20i	29
6.3	Connecting the iSleep 20i to the Power Source	29
6.4	Connecting the Patient Circuit	30
7	Setting up the iSleep 20i	31
7.1	Settings Applicable for iSleep 20i	31
7.2	Setting the Parameters	31
7.3	Viewing Device Information	34
8	Indications	36
9	Cleaning the iSleep 20i and Replacement of Accessories	40
9.1	Cleaning the iSleep 20i	40
9.2	Cleaning and Replacing the Patient Air Filter	42

10	Maintenance	43
10.1	Regular Maintenance Control	43
10.2	Service and Repair.....	44
10.3	Storage.....	44
10.4	Disposal	44
11	Technical Specifications	45
11.1	Data	45
12	Accessories.....	47
12.1	Breas Accessories List.....	47

1 Intended Use of the iSleep 20i



WARNING!

iSleep 20i must only be used:

- For the intended treatment in accordance with this manual and with the instructions given by the responsible clinical personnel.
- In accordance with the operating conditions specified in this manual.
- In original and unmodified shape and only with accessories specified or approved by Breas Medical AB.

Every other use may lead to risk of personal injury!



CAUTION!

Read this manual thoroughly so that you completely understand how the iSleep 20i is operated and maintained before taking it into use, to ensure correct usage, maximum performance and serviceability.



WARNING!

Do not use the iSleep 20i for any kind of life support treatment.



Breas Medical AB reserves the right to make changes to this product without any prior notification.

1.1 What is the iSleep 20i?

The iSleep 20i is a CPAP system that provides a continuous positive airway pressure. This can prevent the user's upper airways from collapsing and therefore avoid breathing problems associated with airway collapse and obstruction.

The pressure delivered by the iSleep 20i can be set either:

- to a constant pressure level (constant CPAP mode), or
- to permit self-adjustment in response to the patient's breathing (self adjusting intelligent CPAP mode, iMode).

The appropriate pressure for CPAP therapy often varies during sleep. In the iMode, the iSleep 20i uses an airflow sensor and an advanced signal processing technique to detect various breathing patterns and to provide the appropriate CPAP treatment.

The iSleep 20i has a pressure sensor that continuously monitors output pressure to the patient and reference ambient pressure, so that the device automatically will compensate for altitude changes.

The iSleep 20i has a memory that stores the usage, and can be downloaded by your care provider to a PC.

1.2 Indications for Use

The iSleep 20i is intended for non-invasive use.

The iSleep 20i shall only be used by patients with spontaneous breathing.

The CPAP function is intended to deliver continuous positive airway pressure therapy for the treatment of obstructive sleep apnea in adults (who weigh more than 30 kg).

The iSleep 20i can be used in clinical settings (e.g., hospitals, sleep laboratories, sub-acute care institutions) and home environments. It must always be prescribed by a licensed physician.

The iSleep 20i is intended to be operated by trained users and qualified personnel.



The iSleep 20i is not intended for life support or life-sustaining applications or for transport of critical care patients.

1.3 Contraindications

Therapy with the iSleep 20i should not be prescribed when the following specific diseases or conditions are present:

- Bullous lung disease
- Pathologically low blood pressure
- Severe cardiac arrhythmias

- Unstable angina pectoris
- Decompensated cardiac failure or hypotension, particularly if associated with intravascular volume depletion
- Recent thoracic surgery
- Pneumothorax
- Pneumomediastinum
- Massive epistaxis or previous history of massive epistaxis (risk of recurrence)
- Pneumoencephalus, recent trauma or surgery that may have produced cranio-nasopharyngeal fistula
- Cerebral spinal fluid (CSF) leaks
- Acute or unstable respiratory failure or insufficiency

Caution should be used when prescribing CPAP therapy for susceptible patients, such as patients with abnormalities of the cribriform plate, or prior history of head trauma.

The use of CPAP therapy may be temporarily contraindicated if the patient exhibits signs of a sinus or middle ear infection.

1.4 About this Manual



Always read this manual before setting up and using the iSleep 20i or performing maintenance on the iSleep 20i, to ensure correct usage, maximum performance and serviceability.



Breas Medical AB reserves the right to make changes to the contents of this manual without any prior notification.

Audience





This manual is intended for patients and other lay users operating the iSleep 20i.



Care providers, clinical personnel, physicians and others who require a working knowledge of the iSleep 20i will find additional information on settings and functions in the Clinician's Manual.

Icons

In this manual, icons are used to highlight specific information. The meaning of each icon is explained in the table below.

ICON	EXPLANATION
	Warning! Risk of death and serious personal injury.
	Caution! Risk of minor or moderate injury. Risk of equipment damage, loss of data, extra work, or unexpected results.
	Note Information that may be valuable but is not of critical importance, tips.
	Reference Reference to other manuals with additional information on a specific topic.

2 Safety Information

2.1 General User Precautions



- The iSleep 20i should not be used for any kind of life support treatment.
- The iSleep 20i shall only be used by patients with spontaneous breathing.
- If you are admitted to a hospital or are prescribed any other form of medical treatment, always inform the medical staff that you are on CPAP treatment.
- The iSleep 20i must only be used:
 - for the intended treatment in accordance with this user manual and with the instructions given by the responsible clinical personnel;
 - in accordance with the operating conditions specified in this manual;
 - in original and unmodified shape and only with accessories specified or approved by Breas Medical AB.
- Do not use the iSleep 20i and contact your responsible care provider for an inspection in the event of suspected damage to the device, unexplainable or sudden pressure, performance or sound changes during operation, or if the delivered air from the iSleep 20i is abnormally hot or emits an odour.
- The iSleep 20i therapy settings must always be based on medical advice and must be carried out by authorized personnel only.
- Always perform the procedure “Checking the iSleep 20i before Use” on page 23 before use.
- Inadequate use of device or accessories may cause loss of treatment or decreased performance.



- U.S. Federal law restricts this device to sale by or on order of a physician.
- Clinical personnel and the patient must read the manual thoroughly and understand the usage of the iSleep 20i before setting up and using the iSleep 20i.
- Handle the iSleep 20i with care.
- Do not use the iSleep 20i while in bag.

2.2 Electrical Safety



- Do not operate the iSleep 20i if it has a damaged power cord, power supply or casing.
- The iSleep 20i may not work properly if any part has been dropped, damaged or submerged in water.
- To avoid electrical shock, disconnect the electrical supply to the iSleep 20i before cleaning. Do not immerse the iSleep 20i into any fluids.
- The operator shall not touch accessible contacts of connectors and the patient simultaneously.
- When handling the HA 01 humidifier, disconnect the iSleep 20i from any power source.



- If an external battery is used it must be disconnected when the iSleep 20i is switched off. Otherwise the battery will discharge.
- The performance of the iSleep 20i may deteriorate at:
 - AC supply voltage below -15% and above +10% of declared nominal value.
 - DC supply voltage below -15% and above +25% of declared nominal value.

2.3 Environmental Conditions



- Do not use the iSleep 20i in any toxic environment.
- Do not use the iSleep 20i in environments where there are explosive gases or other flammable anesthetic agents present.



- The performance of the iSleep 20i may deteriorate at:
 - ambient temperatures below 41°F (5°C) and above 104°F (40°C).
 - ambient relative humidity below 10% RH (relative humidity) and above 95% RH.
 - atmosphere pressure below 700 mbar and above 1060 mbar.
- Do not use the iSleep 20i while positioned in a warm place, such as direct sunlight.
- The device complies with the EMC requirements of standards. Measures should include but not be limited to:
 - normal precautions with regard to relative humidity and conductive characteristics of clothing in order to minimize the build-up of electrostatic charges.
 - avoiding use of radio emitting devices closer than 1 m to the iSleep 20i. Radio emitting devices are for example cellular or cordless telephones, microwave ovens and high-frequency surgery apparatus.
- The iSleep 20i, any accessories and all replaced parts must be disposed of in accordance with the local environmental regulations regarding the disposal of used equipment and waste.
- The performance of the iSleep 20i and treatment of the patient may deteriorate if the operation conditions in “Technical Specifications” on page 45 are not fulfilled. Do not use the iSleep 20i immediately after storage or transport outside the recommended operating conditions.

2.4 Usage of Patient Circuit



- Only use the iSleep 20i with a mask and a patient tube recommended by Breas Medical AB and your health care professional.
- Do not breathe in the connected patient circuit unless the iSleep 20i is turned on and operating properly.
- Do not use patient hoses or tubes made of electrically conductive or static material.
- Patient connected parts and filter must be replaced regularly to ensure correct function of the iSleep 20i. All replaced parts must be disposed of according to local environmental regulations regarding the disposal of used equipment and parts.
- If the patient is using a full face mask (covering mouth and nose), the mask must be equipped with a safety entrainment valve.
- Make sure that the leakage ports are never blocked or obstructed. These ports are used for ventilating the mask in order to prevent re-breathing of exhaled air. Re-breathing of exhaled gases for longer than a few minutes can, in some circumstances, lead to suffocation.
- At low CPAP pressures, the air flow through the leakage ports may be inadequate to clear all exhaled gases from the mask. Some re-breathing may occur.

2.5 Usage of Filters



- Always use the iSleep 20i with a patient air inlet filter installed. Only use filters that are specified in this manual.
- Replace or clean the filters regularly to ensure correct function of the iSleep 20i, especially when changing patient. Failure to replace or clean a dirty filter may cause the iSleep 20i to operate at higher temperatures than intended.
- When operating the iSleep 20i, make sure that the air inlet and the filter is not obstructed or occluded.

2.6 Cleaning and Maintenance



- The iSleep 20i shall be cleaned and maintained in accordance with this user manual.
- Do not attempt to autoclave or sterilise the iSleep 20i.
- The iSleep 20i shall be subjected to maintenance, service and control and any applicable upgrades, in accordance with Breas service instructions.
- The iSleep 20i should only be repaired or modified in accordance with Breas service manuals, technical bulletins, and any special service instructions, by service technicians authorized by Breas Medical AB.
- Do not under any circumstances attempt to service or repair the iSleep 20i yourself. If you do so, the manufacturer will no longer be responsible for the performance and safety of the iSleep 20i.

2.7 Adverse Patient Symptoms



If the patient experiences any of the following symptoms while using the iSleep 20i, a physician or responsible clinician shall be contacted immediately:

- Bloating feeling from excessive swallowing of air while awake
- Air continually leaking from the mouth while sleeping
- Dryness of air passages or nose
- Ear pain, runny nose or sinus discomfort
- Day time sleepiness
- Disorientation or memory lapse
- Mood change or irritability
- Skin sensitivity
- Morning headache
- Severe headache
- Chest discomfort
- Shortness of breath

2.8 Usage of the HA 01 Humidifier



- The HA 01 humidifier and the iSleep 20i are intended for non-invasive use.
- When using an external humidifier, it should be located lower than the iSleep 20i and the patient to prevent personal injury from accidental spillage.
- When using the HA 01 humidifier, the iSleep 20i should be located lower than the patient to prevent personal injury from accidental spillage.
- If a room humidifier is used, place it at least 6 feet (2 meters) away from the iSleep 20i.
- Periodically check for moisture in the patient circuit. When present, remove the moisture. Before attempting to dry the circuit, disconnect it from the iSleep 20i to ensure no water back-flow into the iSleep 20i. The frequency at which these checks must be performed will depend on the patient's own condition and the device used. This should be assessed on an individual basis in accordance with the patient's needs.
- If the condensation in the patient circuit is excessive, the use of a heated humidifier may require the installation of a water trap in the circuit. The water trap prevents any condensed water in the patient circuit from running into the patient airways and causing personal injury.



- The HA 01 humidifier shall be disconnected from the iSleep 20i during transportation.
- The iSleep 20i shall not be placed in the bag with the HA 01 humidifier attached.

2.9 Usage of Oxygen



- The presence of oxygen can speed up combustion of inflammable materials.
- If oxygen has been prescribed, connect the oxygen supply tube to the appropriate oxygen port of the nasal mask or breathing system connector.
- At a fixed flow rate of supplemental oxygen flow, the inhaled oxygen concentration will vary, depending on the pressure delivered, patient's breathing pattern, mask selection, and leak rate.
- When oxygen is used with the iSleep 20i, the oxygen flow must be turned off when the iSleep 20i is not operating. If the iSleep 20i is not in operation, and the oxygen flow is left on, oxygen delivered into the patient tubing may accumulate within the iSleep 20i enclosure. Oxygen accumulated in the iSleep 20i enclosure will create a risk of fire.
- Ventilate the room adequately.
- Do not smoke in a room where oxygen is being used.
- Naked light bulbs and other sources of ignition must be kept a minimum of 6 feet (2 meters) away from the oxygen cylinder or any part of the patient circuit.
- Do not use aerosols or solvents close to the oxygen supply, even when the oxygen supply is shut off.

3 Product Description

3.1 Main Components

The iSleep 20i system contains the following components:

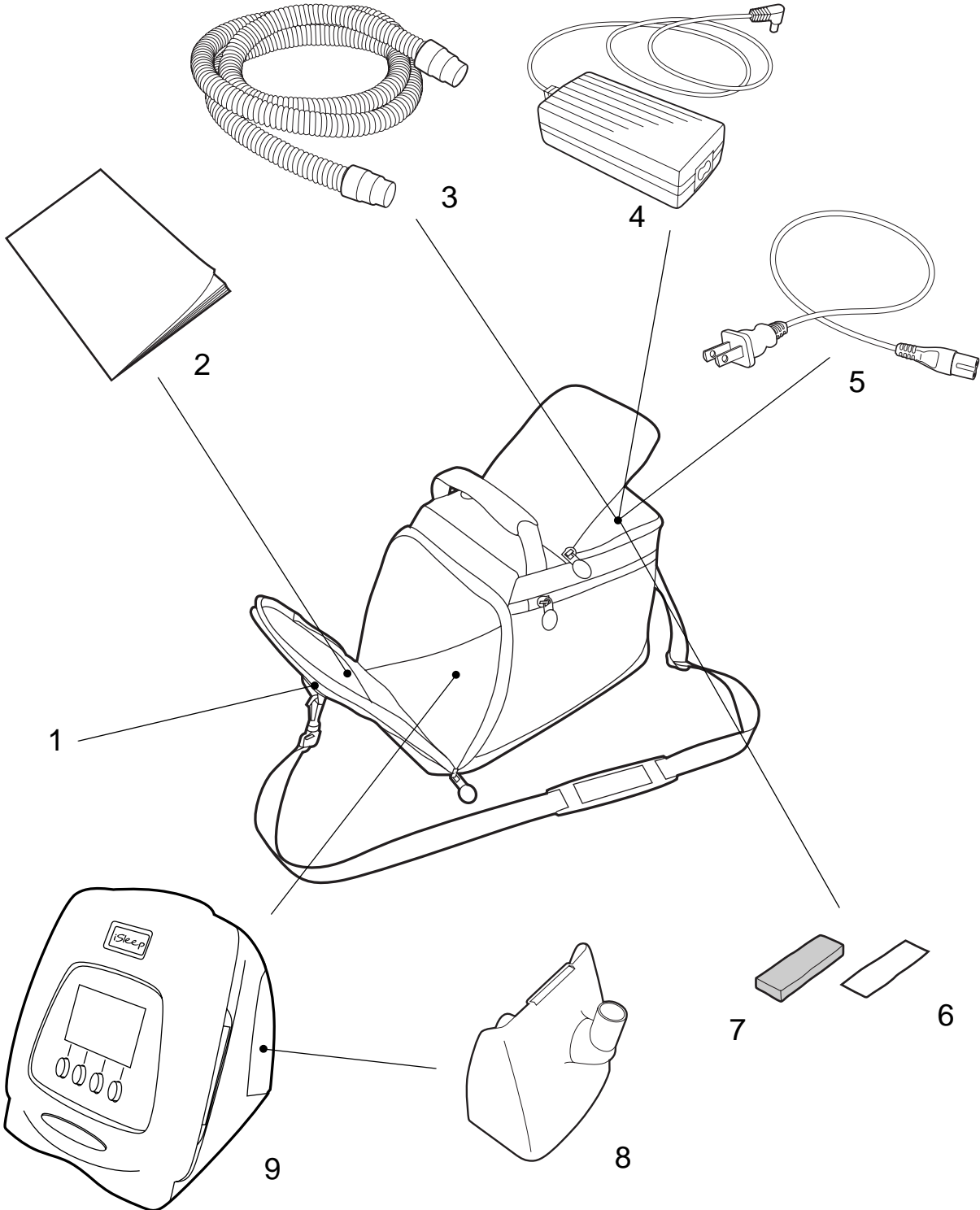

No.	COMPONENT	FUNCTION	PART NO.
1*	Carrying bag	Storage for transportation	003793
2	Users manual	Product and usage information	004050
3	Patient tube	Tube for mask and iSleep 20i	000245
4	iSleep 20i power supply		003773
5	AC power cord		003725
6	Filter (white, disposable, optional)	Inlet air filtration	004153 (5 pcs)
7	Filter (grey, washable)	Inlet air filtration	004154 (5 pcs)
8	Rear lid	Usage without HA 01 Humidifier	003591
9	iSleep 20i main unit		

* Not included in the iSleep 20i basic package.

3.2 Accessories

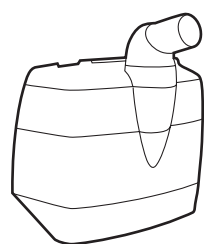

10

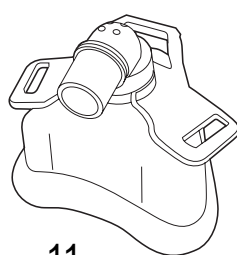

11

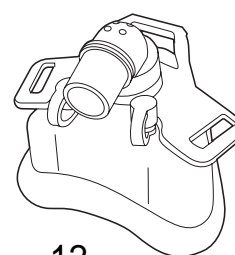

12

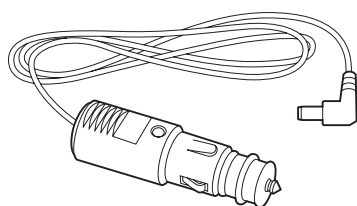

13

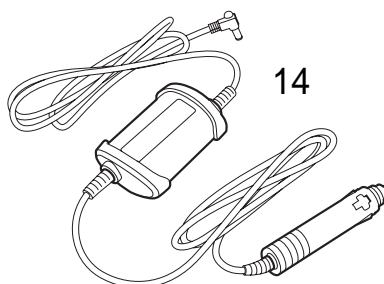

14

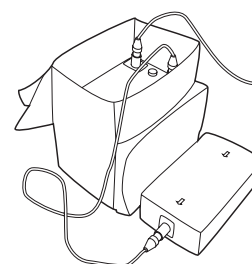

15

No.	COMPONENT	FUNCTION	PART NO.
10	HA 01 Humidifier	Patient air humidification	003530
11	iMask 100		003971
12	iMask 200		003972
13	Battery cable 24 V DC		004367
14	DC/DC converter 12-24 V		004139
15	EB 2 Battery kit	Includes: <ul style="list-style-type: none"> • Charger • Trafobox • Isolation • Battery pack • Carry bag • Power cord 24 V AC • Power cord 24 V DC • Power cord mains • EB 2 User manual 	004152

3.3 The iSleep 20i's Front Panel

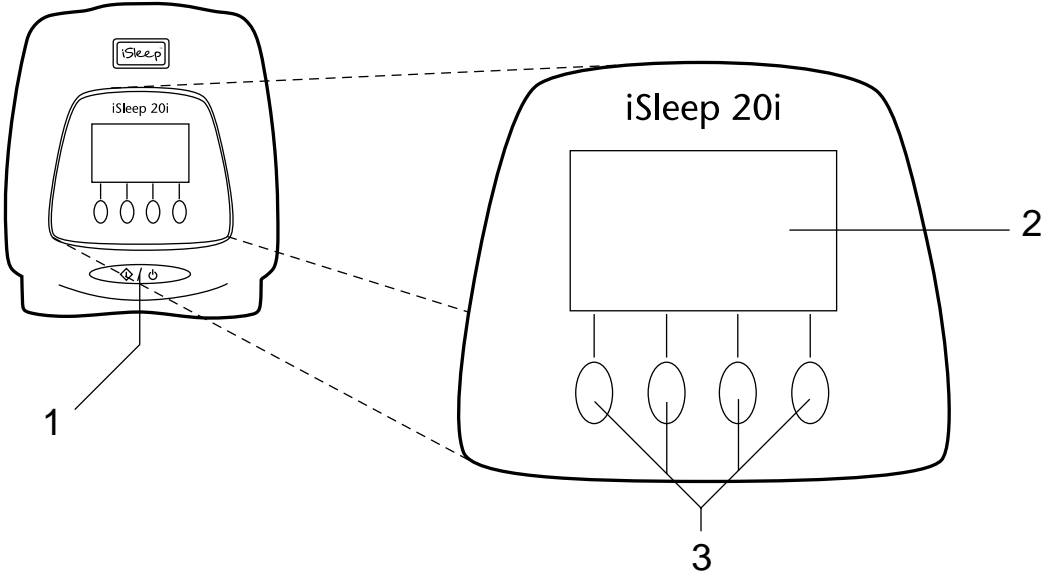

No.	USER BUTTONS AND DISPLAYS	FUNCTION
1	Start/Stop	Main unit: On/Off
2	Display window	Mode and settings display
3	Navigation	Navigation in menu system

3.4 The iSleep 20i's Side Panels

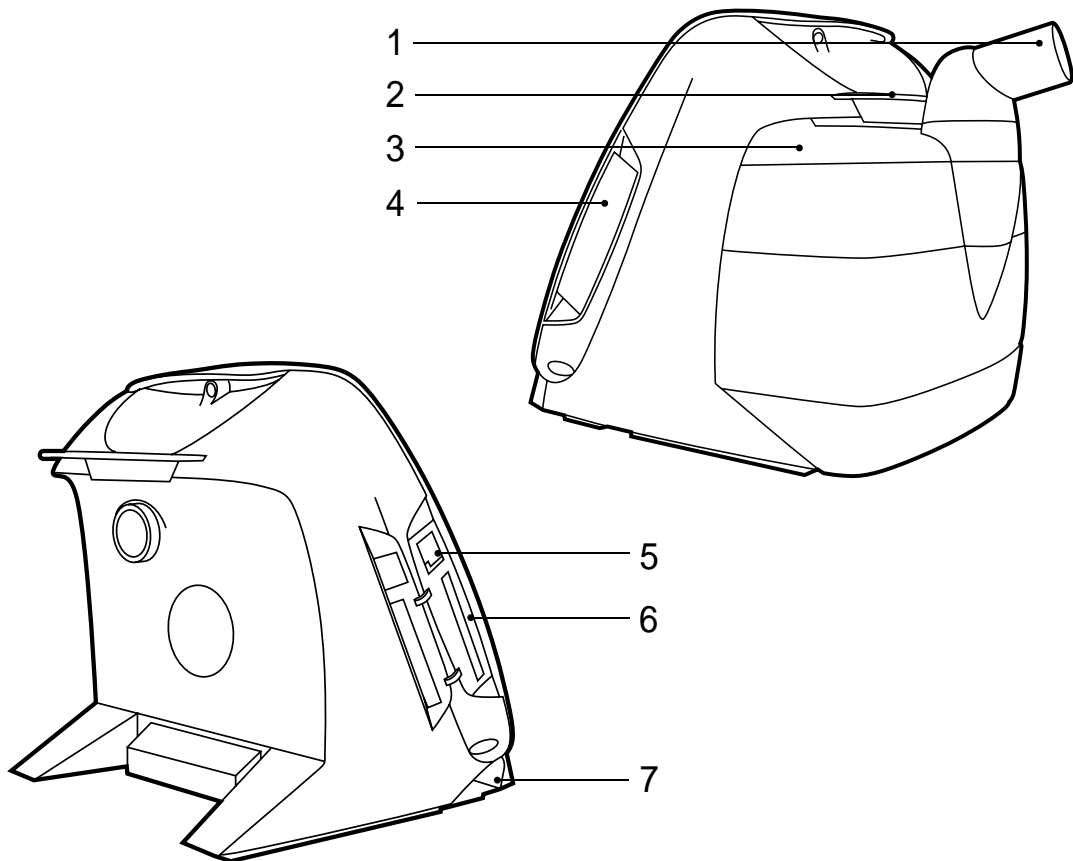

No.	ITEM	FUNCTION
1	Air outlet	Air path out to the patient
2	Locking mechanism	Release and lock HA 01 humidifier or rear lid
3	HA 01 Humidifier (optional)	Patient air humidification
4	Air inlet	Air path in, replaceable filters
5	Data connection	Data cable connection
6	Memory card slot	Read and write memory card
7	DC inlet	External DC power connection

3.5 Equipment Designation and Safety Label

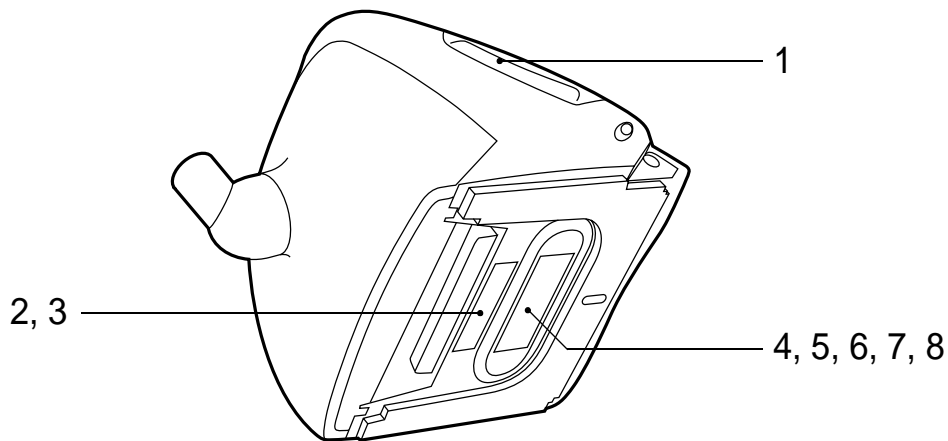

No.	SYMBOL	EXPLANATION
1		Data connection port (for iCom or PC)
2		Model designation
3		Serial number (the last seven alphanumeric characters)
4		Class II electrical equipment; dual isolation
5		Body floating (IEC 60601-1 Type BF, Isolated Applied Part)
6		Read the User Manual thoroughly before connecting the iSleep 20i to the patient.
7		CE marking applies in accordance with the directive MDD 93/42/EEC.
8		Read “Disposal” on page 44 for information about recycling and disposal.

4 Functions and Parameters of the iSleep 20i

This chapter includes descriptions of the functions and settings used for controlling the functions of the iSleep 20i.

4.1 Function Modes

The following modes can be selected for the iSleep 20i:

- iMode (self-adjusting intelligent CPAP mode)
- CPAP mode (Continuous Positive Airway Pressure)

4.2 Settings

All the parameters that are used for controlling the breathing by the iSleep 20i are listed below.

iMode

Minimum pressure (Pmin): The lowest pressure permitted during iMode.

Maximum pressure (Pmax): The highest pressure permitted during iMode.

The Ramp Function (iMode)

The ramp function in iMode provides a pressure increase from the ramp start pressure to the set minimum pressure during a set time. During the Ramp Time the i-algorithm is disabled. The minimum Ramp Time is 5 minutes and can not be disabled.

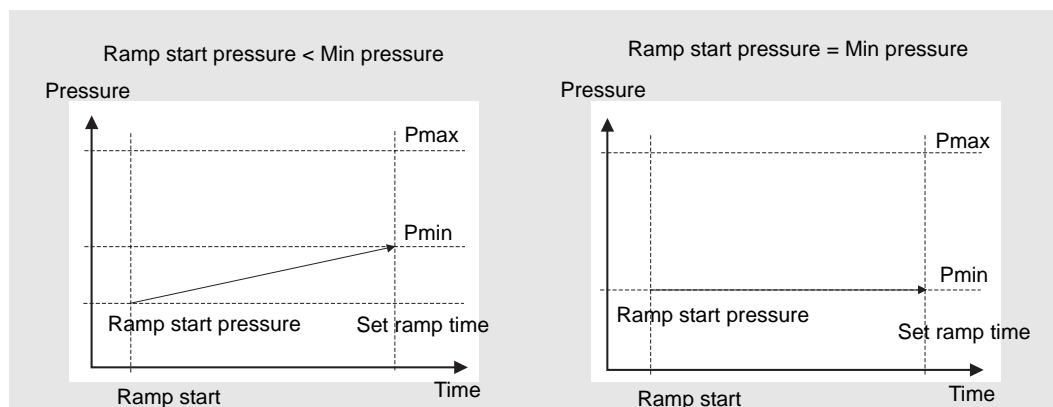

The Ramp Function (CPAP)

The ramp function provides a pressure increase from the ramp start pressure to the set CPAP pressure during a set time.

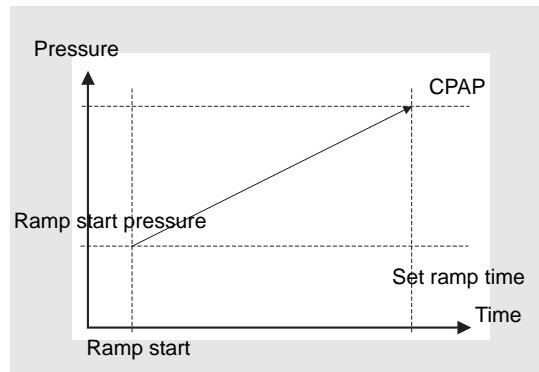

The ramp function will not be available if your care provider has chosen to deactivate it.

Mask Off Detection

The iSleep 20i automatically detects if the mask is taken off during operation and reduces the air flow after approximately 30 s.

Snooze

The snooze function allows the patient to pause the treatment.

Humidifier (optional)

The humidifier function is adjustable to provide additional humidity to the patient air.

Automatic Restart After Power Fail

The iSleep 20i will restart after a power failure with a duration shorter than 5 seconds.

Wake Up (optional)

The wake up function will initiate an alarm at a set time when activated.

5 Using the iSleep 20i

5.1 Checking the iSleep 20i before Use

Always make the following checks before using the iSleep 20i:

- 1 Connect a cleaned or a new patient circuit to the iSleep 20i.
- 2 Connect the iSleep 20i to the AC supply.
- 3 Check patient settings.
- 4 Switch on the iSleep 20i by pressing the Start/Stop button on the front panel. Ensure that the iSleep 20i is running.
- 5 Put on the mask and adjust its fit.
- 6 Ensure that the settings are adjusted as prescribed.

The iSleep 20i is ready for use.

5.2 Switching the iSleep 20i On and Off

- 1 Make sure the power supply is connected.

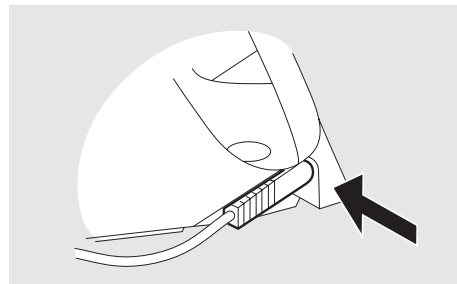

- 2 Turn on the iSleep 20i by pressing the Start/Stop button on the front panel for 2 seconds.

This operation switches the iSleep 20i between standby and operating mode.

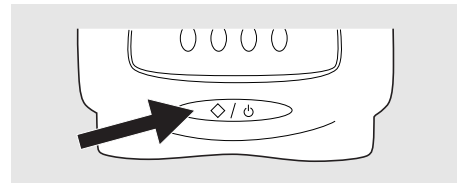

The iSleep 20i is connected to a power supply when the LCD display is lit up.

5.3 Using the Menu



Read chapter “The iSleep 20i's Front Panel” on page 18 for exact position of the buttons.

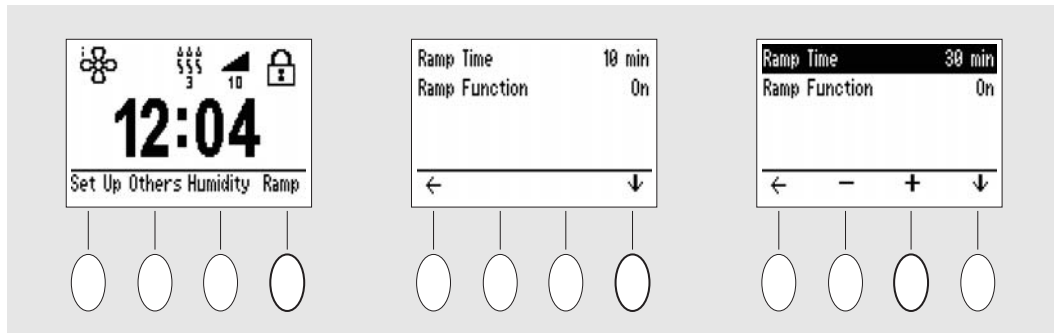

Use the 4 buttons under the display to navigate in the menu. Depending on the location in the menu, the buttons have different function and are called “soft buttons”. The following icons are used:





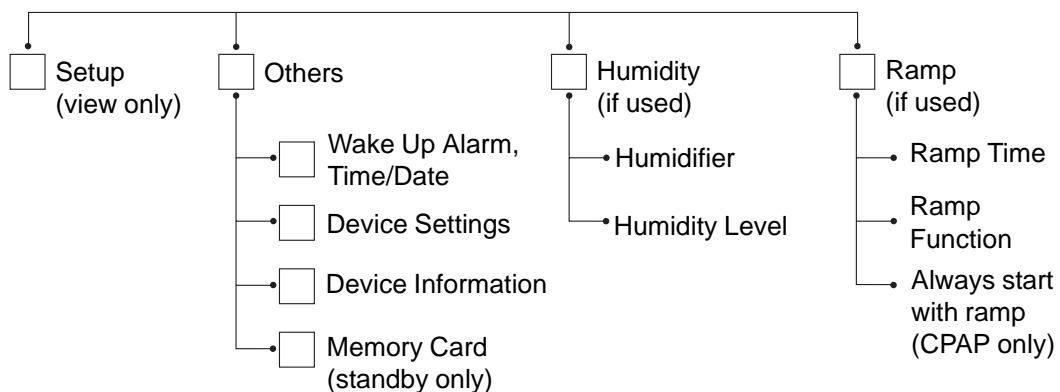

ICON	EXPLANATION
+	Increase the selected value or turn a function On.
-	Decrease the selected value or turn a function Off.
←	Move up one step in the menu system.
↓	Enter the menu or select the value below.

Overview

The iSleep 20i menu has the following layout:



Icons in the Display Window

ICON	EXPLANATION
	The iSleep 20i is operating
	Wake Up Alarm
	Humidity
	Ramp
	Panel lock
	Panel lock

5.4 Using the integrated HA 01 Humidifier



Read the chapter “Usage of the HA 01 Humidifier” on page 13 carefully to make sure all conditions are fulfilled and considered.



See chapter “Humidifier (optional)” on page 32 for instructions how to set up the HA 01 humidifier.

Instructions about safety, warnings, product description, using, cleaning and technical information can be found in the Breas HA 01 humidifier User Manual.



If the HA 01 humidifier is refilled according to instructions after usage, the iSleep 20i will remember the humidity setting used.

The HA 01 humidifier is intended to humidify the patient air. The HA 01 humidifier must be installed in order to access and navigate to this setting.

A full HA 01 humidifier will be able to humidify the air for about 11 hours with the following settings and conditions:

SETTING	VALUE
Humidifier setting	5
CPAP pressure	10 cmH ₂ O

SETTING	VALUE
Ambient temperature	68°F (20°C)
Leakage	20 l/min
Altitude	Sea level

5.5 Using an External Battery

The iSleep 20i can be powered from:

- The Breas external EB 2 Battery Pack.
- A 12 V external power source. The iSleep DC/DC converter 12-24 V needs to be used.
- A 24 V external power source. The iSleep battery cable needs to be used.

1 Connect the external DC cable to the iSleep 20i. Make sure it is fitted correctly.

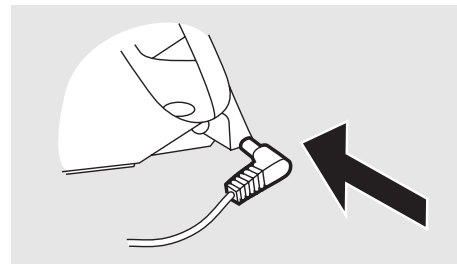

2 Connect the other end of the cable to the battery source.



- Always make a function check to test the battery condition before operating the iSleep 20i from an external battery source.
- The battery must be disconnected when the iSleep 20i is switched off, otherwise the battery will be discharged.

Battery Operation Time

The operation time is dependent on the battery condition, its capacity, the ambient air temperature and the iSleep 20i pressure setting.

The operation time is based on the following settings:

SETTING	VALUE
Humidifier setting	5 or Off
CPAP pressure	10 cmH ₂ O

ENVIRONMENTAL CONDITIONS	
Ambient temperature	68°F (20°C)
Altitude	Sea level
Battery status	New battery fully charged

BATTERY TYPE	HUMIDIFIER	OPERATION TIME
EB 2 (24 V, 7.2 Ah)	Off	13 h
EB 2 (24 V, 7.2 Ah)	5	Not recommended
Car battery (12 V, 60 Ah)*	Off	90 h
Car battery (12 V, 60 Ah)*	5	25 h

* When using a 12 V external power, the iSleep DC/DC converter 12-24 V needs to be used.

6 Preparing the iSleep 20i for Use



Read the chapter “Safety Information” on page 7 before setting up and using the iSleep 20i.

6.1 Installing the iSleep 20i

When using the iSleep 20i for the first time, follow the instructions below:

1 Check that all main components and ordered accessories have been delivered (refer to the packing note or the invoice, if available).

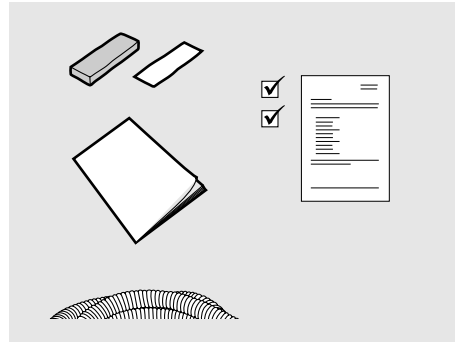

2 Ensure that the equipment is in good condition.

3 Check that the mandatory grey patient air filter is installed.

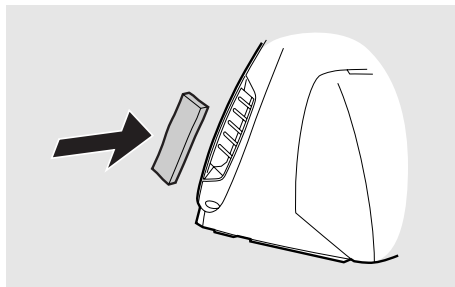

6.2 Placing the iSleep 20i



Read the chapter “Environmental Conditions” on page 9 carefully to make sure all conditions are fulfilled and considered.

1 Place the iSleep 20i on a solid, flat surface. The iSleep 20i should be placed lower than the patient in order to prevent the device from falling on the patient, as well as preventing condensed water to reach the patient.

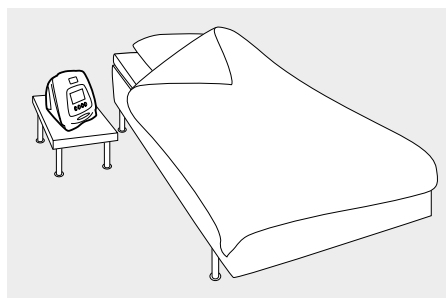

2 Make sure that nothing can block the patient air inlet at the side of the iSleep 20i.

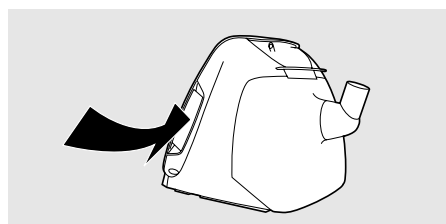

6.3 Connecting the iSleep 20i to the Power Source



Read the chapter “Electrical Safety” on page 8 carefully to make sure all conditions are fulfilled and considered.

To Connect the iSleep 20i to the Power Source:

1 Plug the power supply into the power inlet of the iSleep 20i.

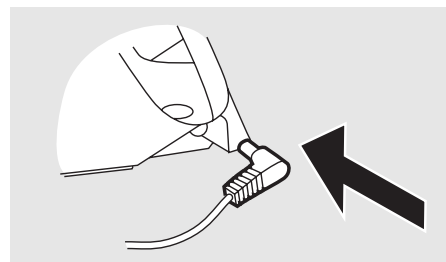

2 Connect the power cord into the power supply.

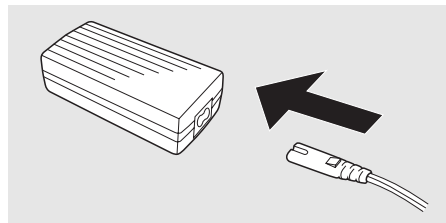

3 Connect the power cord to the power source.

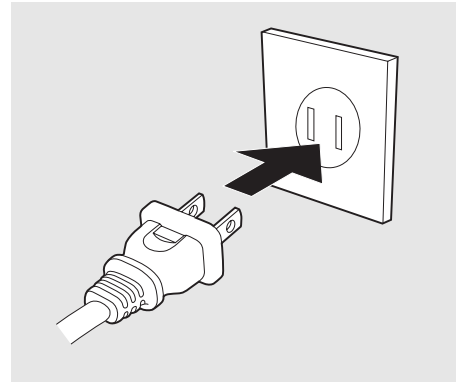

6.4 Connecting the Patient Circuit



Read the chapter “Usage of Patient Circuit” on page 10 carefully to make sure all conditions are fulfilled and considered.

1 Connect the patient tube to the air outlet.

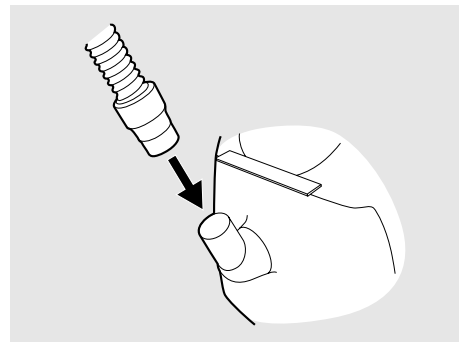

2 Connect the other end of the patient tube to the mask and the leakage port, if applicable.

Mask Leakage

The leakage from the mask should be at least 12 l/min at 4 cmH₂O, to prevent re-breathing of exhaled air. The recommended mask leakage is 20-40 l/min at 10 cmH₂O pressure.

This leakage may be achieved by:

- small holes in the mask
- an adjoining leakage port



In order to receive a suitable leakage the Breas iMask™ Nasal CPAP Mask is recommended.

7 Setting up the iSleep 20i



The configuration of the iSleep 20i therapy settings must always be prescribed by a licensed physician and carried out by an authorized health care professional.



For more information about the Breas iSleep 20i's settings, please contact your care provider.

7.1 Settings Applicable for iSleep 20i

SETTING	RANGE	RESOLUTION
Min pressure	4 cmH ₂ O to Pmax	0.5 cmH ₂ O
Max pressure	Pmin to 20 cmH ₂ O	0.5 cmH ₂ O
Ramp time	5 to 60 min	5 min
Humidifier	Off, 1 to 9	1



The operation modes and setting parameters are described in detail in the chapter “Functions and Parameters of the iSleep 20i” on page 21.

7.2 Setting the Parameters



For more information about how to use the menu, please read the chapter “Using the Menu” on page 24.

Study the overview picture in “Using the Menu” on page 24 if a page or section can not be found.

The Ramp Function

Setting range: 5 to 60 min.

Resolution: 5 min.

Navigate to the “Ramp” section. The ramp function can only be activated during operation.

When the “Ramp” section is available in the menu, the ramp function can be activated by pressing and holding the “Ramp” soft button until the ramp symbol appears.

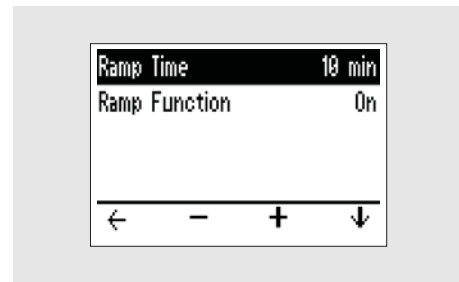

The first time the ramp function is activated, the iSleep 20i will immediately start the ramp. The following activations in the same treatment session will have a 10 second delay before starting the ramp function. This is indicated by flashing the ramp indication.

Humidifier (optional)

Setting range: 1 to 9, Off (where 9 is the maximum humidity).

At the main menu, choose “Humidity” to navigate to the humidifier section. If the HA 01 humidifier is not attached to the iSleep 20i, the “Humidity” section will not be available in the menu.

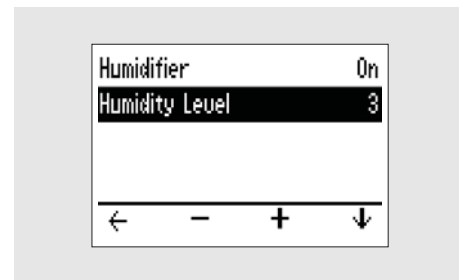

When the “Humidity” section is available in the menu, the HA 01 humidifier can be activated and deactivated by pressing and holding the “Humidity” soft button until the humidity symbol appears/disappears.

Always set the humidity control to the setting recommended by your doctor.



The HA 01 humidifier can only be activated during operation.

Mask Off Detection

If the patient removes the mask, the iSleep 20i will reduce the air flow after approximately 30 s. When the patient has put on the mask again and taken a few breaths, the iSleep 20i will go back to the pressure delivered before the patient removed the mask.

The iSleep 20i will exclude any mask off time and ramp time when registering the patient operating time.



If the mask is not fitted properly to the patient, the iSleep 20i may incorrectly detect that the mask is taken off and may change the delivered pressure to the reduced mask off level. In this case, check the mask fitting and adjust it if necessary.

Snooze

The snooze is activated by shortly pressing the Start/Stop button.

When the snooze is started, the display will lighten up and the iSleep 20i delivers a low flow.

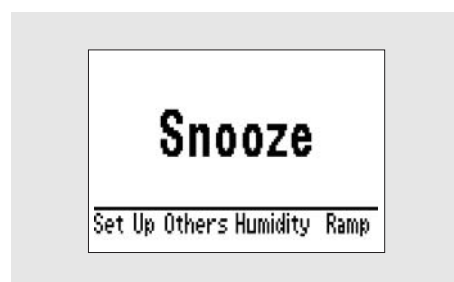

In order to start the treatment again, start to breath in the mask or press the Start/Stop button shortly. The iSleep 20i will then increase the pressure to the set level during up to 10 seconds.



- The iSleep 20i will turn off automatically after 10 minutes of inactivity once the snooze function has been activated.
- Once the snooze is activated, and the mask has not been taken off within 10 seconds, the pressure will rise to the pressure set before the snooze function was activated.

Wake Up (optional)

Navigate to the “Others” section and choose “Wake Up Alarm, Time/Date”.

Activate the “Wake Up Alarm” by setting it to “On”. Set the “Wake Up Time” using the “+” and “-” soft keys.

The wake up function will initiate an alarm at the set time when activated. Press the Start/Stop button to turn off the alarm.

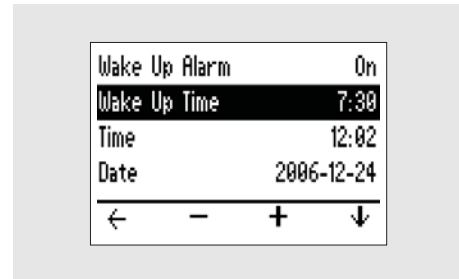

The wake up alarm is active when the wake up alarm icon is visible in the main menu.

7.3 Viewing Device Information



Check the chapter “Using the Menu” on page 24 for information about how to navigate to the device info screen.

At the main menu, choose “Others” and navigate to the “Device Information” page.



The “Device Information” page contains the following information:

1 Total Operating Time:

Total number of hours the iSleep 20i has been operating.

2 Patient Operating Time:

Total number of hours a patient has been using the iSleep 20i for CPAP treatment (ramp and mask off not included).

3 Firmware Version.

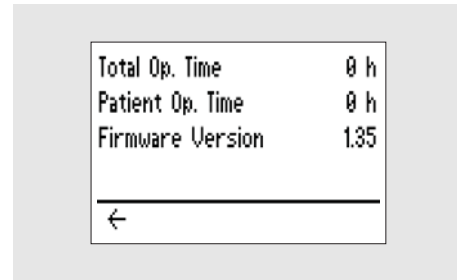

Total Op. Time	0 h
Patient Op. Time	0 h
Firmware Version	1.35
<hr/>	
←	

8 Indications



This chapter describes the iSleep 20i's indication functions, messages shown in the display window.

Power Fail Indication

ITEM	DESCRIPTION
Definition	A power fail indication will be given when the iSleep 20i is disconnected from the AC power source more than 5 seconds.
Action	The iSleep 20i will terminate treatment.
Indication	The indication is asserted with an audibly tone.
Reset	In order to reset the indication press the Start/Stop button.

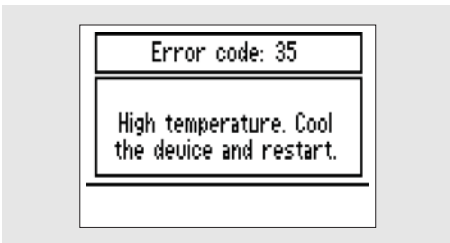
Internal Function Error

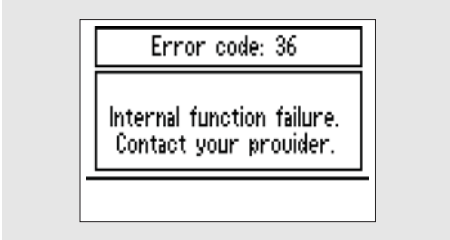
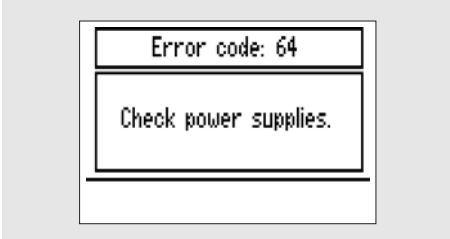
ITEM	DESCRIPTION
	 The Action, Indication and Reset descriptions can be found at the end of this table.
Definition	An internal function error will be given when the iSleep 20i has an internal function failure. The following error codes exist:  35: High temperature. Let the iSleep 20i cool down and restart. The ambient temperature might be too high.

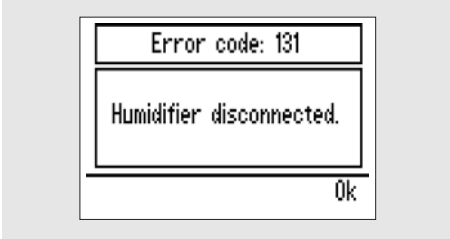
ITEM	DESCRIPTION
	 <p data-bbox="646 555 1098 645">Internal function failure. Note the code number and contact your care provider.</p>
	 <p data-bbox="646 954 1098 1043">64: Low power. Check the power cables and the AC connection.</p>
	 <p data-bbox="646 1352 1098 1442">130: Settings corrupt. Check that the settings of the iSleep 20i are according to prescription.</p>
	 <p data-bbox="646 1751 1098 1930">131: The HA 01 humidifier has been disconnected when the iSleep 20i was running. Always turn of the iSleep 20i before disconnecting the HA 01 humidifier.</p>

ITEM	DESCRIPTION
	<div data-bbox="646 286 1099 533" data-label="Image"> </div> <p data-bbox="646 555 1348 689">The leakage has been too high during the night for an accumulated time longer than 30 minutes. Check the mask fitting.</p>
	<div data-bbox="646 734 1099 981" data-label="Image"> </div> <p data-bbox="646 1003 1348 1182">133: Low humidifier temperature. Check that the HA 01 humidifier is connected correctly (this error is shown after the treatment session). If the error remains, contact your care provider.</p>
	<div data-bbox="646 1227 1099 1473" data-label="Image"> </div> <p data-bbox="646 1496 1348 1675">134: High humidifier temperature. Turn off the iSleep 20i. Disconnect the HA 01 humidifier and reconnect it. If the error remains, contact your care provider.</p>
<p data-bbox="347 1704 464 1738">Action</p>	<p data-bbox="646 1704 1348 1794">The iSleep 20i will continue or stop the treatment depending on the type and priority of the event.</p>
<p data-bbox="347 1821 528 1854">Indication</p>	<p data-bbox="646 1821 1348 1910">The indication is asserted audibly with a tone and visibly by a display message.</p>

ITEM	DESCRIPTION
Reset	If possible, correct the error cause and disconnect and connect the AC power source. If the error remains, contact your care provider.

9 Cleaning the iSleep 20i and Replacement of Accessories

The patient-connected parts and the filter must be cleaned and replaced regularly to ensure correct function of the iSleep 20i. All replaced parts must be disposed of in accordance with local environmental regulations regarding the disposal of used equipment and waste.

9.1 Cleaning the iSleep 20i



To avoid electrical shock, disconnect the power supply to the iSleep 20i before cleaning. Do not immerse the iSleep 20i into any fluids.



- Always be careful when cleaning to ensure that you do not damage any equipment.
- Fluid must not be allowed to enter into the iSleep 20i.

Main Unit

1 Switch off the iSleep 20i and disconnect the power supply.

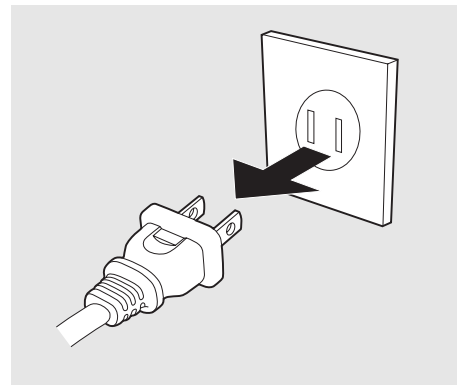

2 Remove the patient circuit.

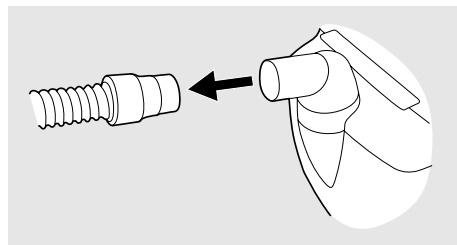

3 Detach the rear lid or the HA 01 humidifier (if mounted).

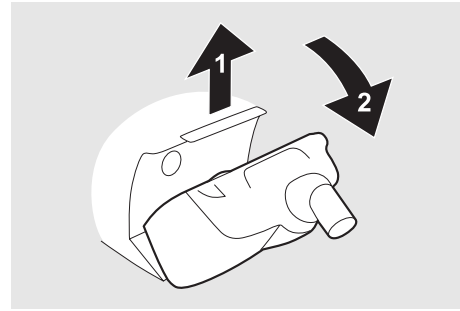

4 Disconnect the cable.

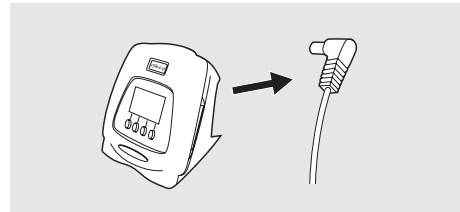

5 Clean the outside of the iSleep 20i using a lint-free cloth and a mild detergent solution.

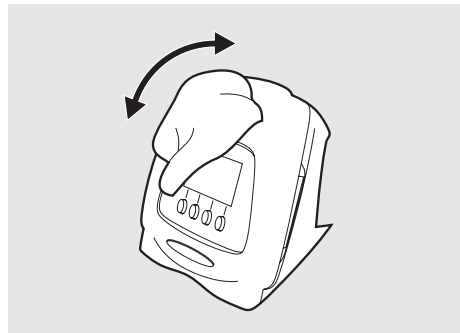

6 Reconnect the cable and the patient circuit. Make sure all parts are dry before the iSleep 20i is put into operation.

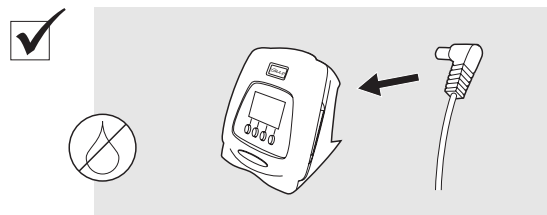

HA 01 Humidifier

The HA 01 humidifier must be cleaned regularly.



Information on cleaning the HA 01 humidifier can be found in the Breas HA 01 humidifier User Manual.

The HA 01 humidifier shall be replaced in intervals according to the manufacturer's instructions. Also check the HA 01 humidifier for damage regularly. In case of damage, replace the HA 01 humidifier.

Patient Circuit



The patient circuit should be cleaned and replaced in accordance with the care provider's instructions.

Always clean the parts or use a new set when used by a new patient.

All parts that come into contact with the respiration gas must be cleaned as follows:

- 1 Place the dismantled parts in hot water containing washing-up liquid.
- 2 Remove fouling with a brush.
- 3 Rinse parts thoroughly under running hot water.
- 4 Shake water out of all parts.
- 5 Dry the parts completely.
- 6 Store in dust-free location.

Check the patient circuit for damage regularly. In case of damage, replace the circuit.

9.2 Cleaning and Replacing the Patient Air Filter

The patient air filter is located on the side of the iSleep 20i. There are two types of filters:

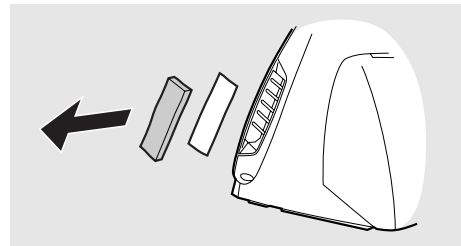

Washable Filter (grey color, mandatory)

Replace the washable filter at least once a year. Wash the filter at least once a week.

- 1 Wash the filter using warm water and a mild detergent.
- 2 Rinse thoroughly.
- 3 Dry the filter by squeezing it out in a towel. Do not wring the filter.

Disposable Filter (white color, optional)

Replace the filter at least every 4th week, or more often when used in high pollution or pollen-rich environments.



Do not wash or reuse the disposable filter.

10 Maintenance



WARNING!

- iSleep 20i should be subjected to maintenance, service and control and any applicable upgrades, in accordance with Breas service instructions.
- iSleep 20i should only be repaired or modified in accordance with Breas service manuals, technical bulletins, and any special service instructions, by service technicians that have been authorized after Breas iSleep 20i service training.
- Do not under any circumstances attempt to service or repair the iSleep 20i yourself. If you do so, the manufacturer will no longer be responsible for the performance and safety of the iSleep 20i.

DEVIATION FROM THESE SERVICE INSTRUCTIONS MAY LEAD TO RISK OF PERSONAL INJURY!

10.1 Regular Maintenance Control

The iSleep 20i should not require any regular maintenance inspections if it is used and maintained in accordance with the instructions in this manual.



Do not use the device and contact your responsible care provider for an inspection of the device in the event of:

- Unexpected patient symptoms during treatment.
- Unexplainable or sudden pressure, performance or sound changes during operation.
- Suspected damage to the device or power supply.

10.2 Service and Repair

The service and repair of the iSleep 20i must only be carried out by authorized service personnel in accordance with Breas service instructions. Service inspections must always be carried out after any repair of the device.



Authorized service workshops can order the iSleep 20i Service Manual that contains all technical documentation required for the maintenance and service of the iSleep 20i.

10.3 Storage

Empty, clean and dry the HA 01 humidifier (if applicable) before storage of the iSleep 20i.

10.4 Disposal

The iSleep 20i, any accessories and all replaced parts must be disposed of and recycled in accordance with the local environmental regulations regarding the disposal of used equipment and waste.

11 Technical Specifications

11.1 Data



The iSleep 20i and its packaging do not contain any natural rubber latex.

SETTING/VALUE	RANGE/SPECIFICATION	RESOLUTION
Min pressure (Pmin)	4 cmH ₂ O to Pmax. Tolerance: ±2% of the maximum value and ±4% of the set value.	0.5 cmH ₂ O
Max pressure (Pmax)	Pmin to 20 cmH ₂ O. Tolerance: ±2% of the maximum value and ±4% of the set value.	0.5 cmH ₂ O
CPAP	4 to 20 cmH ₂ O	0.5 cmH ₂ O
Ramp time	5 to 60 min	5 min
Ramp start pressure	4 cmH ₂ O to CPAP/Pmin	0.5 cmH ₂ O
Humidifier	1 to 9, 10 to 30 mgH ₂ O/l, <100% RH. Heat-up time from 73°F: 1 hour. Max gas temperature at patient port: 106°C.	1
Maximum limited pressure during single fault condition	30 cmH ₂ O	
Max flow in CPAP mode	6.7 cmH ₂ O: 108 l/min 13.3 cmH ₂ O: 132 l/min 20 cmH ₂ O: 132 l/min	
Breathing resistance under single-fault	0.9 cmH ₂ O at 30 l/min 3.2 cmH ₂ O at 60 l/min	
Digital output	0 to 5 V	
Sound level at 10 cmH ₂ O	Less than 30 dB(A). Measured at 1 m.	

INDICATIONS	SPECIFICATION	TOLERANCE
Pressure	0 to 20 cmH ₂ O	
Power fail indication	Message shown in the display.	
Internal function indication	Message shown in the display.	

POWER SUPPLIES	SPECIFICATION
AC supply	100 to 240 V AC, tolerance: -15%/+10%, 50 to 60 Hz, max 140 VA. DC output: 24 V.
External DC supply	24 V DC, tolerance: -15%/+25% (20.4 to 30 V). Max 2.5 A, 60 W with Breas external battery.
Standby power	3 W

ENVIRONMENTAL CONDITIONS	SPECIFICATION
Operating temperature range	41 to 104°F (5 to 40°C)
Storage and transport temperature	-4 to +140°F (- 20 to +60°C)
Ambient pressure range	700 to 1060 mbar
Humidity	10% to 95%, non-condensing

OPERATING CONDITIONS	SPECIFICATIONS
Recommended leakage	20 to 40 l/min at 10 cmH ₂ O
Minimum leakage	12 l/min at 4 cmH ₂ O

DIMENSIONS	SPECIFICATIONS
W × H × D	173 × 172 × 209 mm (with rear lid) 173 × 172 × 201 mm (with HA 01 humidifier)
Weight	1.9 kg (with rear lid), 2.0 kg (with HA 01 humidifier)
Air outlet	22 mm male conical standard connector

12 Accessories

12.1 Breas Accessories List



Only use accessories recommended by Breas Medical AB. Breas Medical AB cannot guarantee the performance and safety for the use of other accessories with the iSleep 20i.

The following Breas accessories are currently available for the iSleep 20i:

DESCRIPTION	PART No.
Carrying bag	003793
Users manual	004050
Patient tube	000245
HA 01 Humidifier	003530
Rear lid	003591
Filter (grey, washable)	004154 (5 pcs)
Filter (white, disposable, optional)	004153 (5 pcs)
iMask 100	003971
iMask 200	003972
Low resistant bacteria filter (303 Respigard-II Filter)	004185
Breas one-size headgear	003434
iSleep 20i power supply	003773
AC power cord	003725
EB 2 external battery pack 24 V DC, including cable, charger and bag	004152
External DC cable (EB 2)	004136
TrafoBox EB 2 external battery	001153
Charger EB 2 external battery	001159
Carrying bag EB 2 external battery	000269
EB 2 power cord	000541

DESCRIPTION	PART No.
Battery cable 24 V DC	004367
iSleep DC/DC converter 12-24 V	004139